

ELEVATION CERTIFICATE

Important: Read the instructions on pages 1-7.

SECTION A - PROPERTY OWNER INFORMATION		For Insurance Company Use:
BUILDING OWNER'S NAME <u>GLEN E. ENGLE</u>		Policy Number
BUILDING STREET ADDRESS (Including Apt., Unit, Suite, and/or Bldg. No.) OR P.O. ROUTE AND BOX NO. <u>4470 FOUNTAIN AVE.</u>		Company NAIC Number
CITY <u>CASCADE</u>	STATE <u>CO</u>	ZIP CODE <u>80809-0447</u>
PROPERTY DESCRIPTION (Lot and Block Numbers, Tax Parcel Number, Legal Description, etc.) <u>LOT 37 BLK 12 RESUB. OF BLKS. 10-13 TOWN OF CASCADE & METES AND BOUNDS PARCEL</u>		
BUILDING USE (e.g., Residential, Non-residential, Addition, Accessory, etc. Use a Comments area, if necessary.) <u>RESIDENTIAL A RESUB. OF BLKS. 10-13</u>		
LATITUDE/LONGITUDE (OPTIONAL) (##-##-##.## or ##.#####)	HORIZONTAL DATUM: <input type="checkbox"/> NAD 1927 <input type="checkbox"/> NAD 1983	SOURCE: <input type="checkbox"/> GPS (Type): <input type="checkbox"/> USGS Quad Map <input type="checkbox"/> Other

SECTION B - FLOOD INSURANCE RATE MAP (FIRM) INFORMATION					
B1. NFIP COMMUNITY NAME & COMMUNITY NUMBER <u>EL PASO UNINCORPORATED AREAS 030058</u>		B2. COUNTY NAME <u>EL PASO UNINCORPORATED AREA</u>		B3. STATE <u>CO</u>	
B4. MAP AND PANEL NUMBER <u>08041C0490</u>	B5. SUFFIX <u>F</u>	B6. FIRM INDEX DATE <u>MAR. 17, 1997</u>	B7. FIRM PANEL EFFECTIVE/REVISED DATE <u>MAR. 17, 1997</u>	B8. FLOOD ZONE(S) <u>AE</u>	B9. BASE FLOOD ELEVATION(S) (Zone AO, use depth of flooding) <u>7385.0</u>
B10. Indicate the source of the Base Flood Elevation (BFE) data or base flood depth entered in B9. <input type="checkbox"/> FIS Profile <input checked="" type="checkbox"/> FIRM <input type="checkbox"/> Community Determined <input type="checkbox"/> Other (Describe):					
B11. Indicate the elevation datum used for the BFE in B9: <input checked="" type="checkbox"/> NGVD 1929 <input type="checkbox"/> NAVD 1988 <input type="checkbox"/> Other (Describe):					
B12. Is the building located in a Coastal Barrier Resources System (CBRS) area or Otherwise Protected Area (OPA)? <input type="checkbox"/> Yes <input checked="" type="checkbox"/> No Designation Date					

SECTION C - BUILDING ELEVATION INFORMATION (SURVEY REQUIRED)	
C1. Building elevations are based on: <input type="checkbox"/> Construction Drawings* <input type="checkbox"/> Building Under Construction* <input checked="" type="checkbox"/> Finished Construction	
*A new Elevation Certificate will be required when construction of the building is complete.	
C2. Building Diagram Number <u>7</u> (Select the building diagram most similar to the building for which this certificate is being completed - see pages 6 and 7. If no diagram accurately represents the building, provide a sketch or photograph.)	
C3. Elevations - Zones A1-A30, AE, AH, A (with BFE), VE, V1-V30, V (with BFE), AR, AR/A, AR/AE, AR/A1-A30, AR/AH, AR/AO	
Complete Items C3.-a-i below according to the building diagram specified in Item C2. State the datum used. If the datum is different from the datum used for the BFE in Section B, convert the datum to that used for the BFE. Show field measurements and datum conversion calculation. Use the space provided or the Comments area of Section D or Section G, as appropriate, to document the datum conversion.	
Datum <u> </u> Conversion/Comments	
Elevation reference mark used <u>RN16</u> Does the elevation reference mark used appear on the FIRM? <input checked="" type="checkbox"/> Yes <input type="checkbox"/> No	
<input type="checkbox"/> a) Top of bottom floor (including basement or enclosure)	<u>7400.1</u> 7398.1 ft.(m)
<input type="checkbox"/> b) Top of next higher floor	<u>7372</u> <u>7403.9</u> ft.(m)
<input type="checkbox"/> c) Bottom of lowest horizontal structural member (V zones only)	<u> </u> ft.(m)
<input type="checkbox"/> d) Attached garage (top of slab)	<u> </u> ft.(m)
<input type="checkbox"/> e) Lowest elevation of machinery and/or equipment servicing the building (Describe in a Comments area)	<u>7400.1</u> ft.(m)
<input type="checkbox"/> f) Lowest adjacent (finished) grade (LAG)	<u>7398.2</u> ft.(m)
<input type="checkbox"/> g) Highest adjacent (finished) grade (HAG)	<u>7398.7</u> ft.(m)
<input type="checkbox"/> h) No. of permanent openings (flood vents) within 1 ft. above adjacent grade	<u>6</u>
<input type="checkbox"/> i) Total area of all permanent openings (flood vents) in C3.h	<u>768</u> sq. in. (sq. cm)

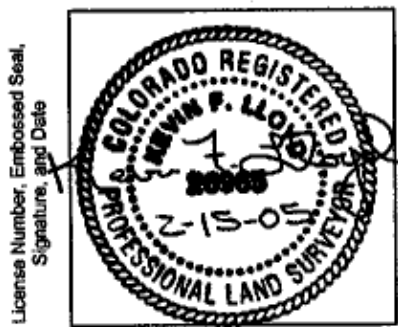

SECTION D - SURVEYOR, ENGINEER, OR ARCHITECT CERTIFICATION			
This certification is to be signed and sealed by a land surveyor, engineer, or architect authorized by law to certify elevation information. I certify that the information in Sections A, B, and C on this certificate represents my best efforts to interpret the data available. I understand that any false statement may be punishable by fine or imprisonment under 18 U.S. Code, Section 1001.			
CERTIFIER'S NAME <u>KEVIN F. LLOYD</u>	LICENSE NUMBER <u>26965</u>		
TITLE <u>PRESIDENT</u>	COMPANY NAME <u>RAMPART SURVEYS, INC.</u>		
ADDRESS <u>P.O. Box 5101</u>	CITY <u>WOODLAND PARK, CO.</u>	STATE <u>CO.</u>	ZIP CODE <u>80866</u>
SIGNATURE <u>Kevin F. Lloyd</u>	DATE <u>2-15-05</u>	TELEPHONE <u>719-687-0920</u>	

IMPORTANT: In these spaces, copy the corresponding information from Section A.		For Insurance Company Use:
BUILDING STREET ADDRESS (Including Apt., Unit, Suite, and/or Bldg. No.) OR P.O. ROUTE AND BOX NO. 4470 FOUNTAIN AVE.		Policy Number
CITY CASCADE,	STATE CO.	ZIP CODE 80809-0447
Company NAIC Number		

SECTION D - SURVEYOR, ENGINEER, OR ARCHITECT CERTIFICATION (CONTINUED)

Copy both sides of this Elevation Certificate for (1) community official, (2) insurance agent/company, and (3) building owner.

COMMENTS

Check here if attachments

SECTION E - BUILDING ELEVATION INFORMATION (SURVEY NOT REQUIRED) FOR ZONE AO AND ZONE A (WITHOUT BFE)

For Zone AO and Zone A (without BFE), complete Items E1 through E4. If the Elevation Certificate is intended for use as supporting information for a LOMA or LOMR-F, Section C must be completed.

- E1. Building Diagram Number __ (Select the building diagram most similar to the building for which this certificate is being completed - see pages 6 and 7. If no diagram accurately represents the building, provide a sketch or photograph.)
- E2. The top of the bottom floor (including basement or enclosure) of the building is __ ft.(m) __ in.(cm) above or below (check one) the highest adjacent grade. (Use natural grade, if available).
- E3. For Building Diagrams 6-8 with openings (see page 7), the next higher floor or elevated floor (elevation b) of the building is __ ft.(m) __ in.(cm) above the highest adjacent grade. Complete items C3.h and C3.i on front of form.
- E4. The top of the platform of machinery and/or equipment servicing the building is __ ft.(m) __ in.(cm) above or below (check one) the highest adjacent grade. (Use natural grade, if available).
- E5. For Zone AO only: If no flood depth number is available, is the top of the bottom floor elevated in accordance with the community's floodplain management ordinance?
 Yes No Unknown. The local official must certify this information in Section G.

SECTION F - PROPERTY OWNER (OR OWNER'S REPRESENTATIVE) CERTIFICATION

The property owner or owner's authorized representative who completes Sections A, B, C (Items C3.h and C3.i only), and E for Zone A (without a FEMA-issued or community-issued BFE) or Zone AO must sign here. *The statements in Sections A, B, C, and E are correct to the best of my knowledge.*

PROPERTY OWNER'S OR OWNER'S AUTHORIZED REPRESENTATIVE'S NAME

ADDRESS	CITY	STATE	ZIP CODE
SIGNATURE	DATE	TELEPHONE	

COMMENTS

Check here if attachments

SECTION G - COMMUNITY INFORMATION (OPTIONAL)

The local official who is authorized by law or ordinance to administer the community's floodplain management ordinance can complete Sections A, B, C (or E), and G of this Elevation Certificate. Complete the applicable item(s) and sign below.

- G1. The information in Section C was taken from other documentation that has been signed and embossed by a licensed surveyor, engineer, or architect who is authorized by state or local law to certify elevation information. (Indicate the source and date of the elevation data in the Comments area below.)
- G2. A community official completed Section E for a building located in Zone A (without a FEMA-issued or community-issued BFE) or Zone AO.
- G3. The following information (Items G4-G9) is provided for community floodplain management purposes.

G4. PERMIT NUMBER	G5. DATE PERMIT ISSUED	G6. DATE CERTIFICATE OF COMPLIANCE/OCCUPANCY ISSUED
-------------------	------------------------	---

- G7. This permit has been issued for: New Construction Substantial Improvement
- G8. Elevation of as-built lowest floor (including basement) of the building is: _____ ft.(m) Datum:
- G9. BFE or (in Zone AO) depth of flooding at the building site is: _____ ft.(m) Datum:

LOCAL OFFICIAL'S NAME	TITLE
COMMUNITY NAME	TELEPHONE
SIGNATURE	DATE

COMMENTS

Check here if attachments